

Instruction Manual

CUBICLE 1 RIGHT

Please use this instruction manual to fix your
DIY toilet cubicle delivered by Cubiclexpress



**CUBICLE
XPRESS**

Delivery at the Speed of Business....

What's in the Box?

1. 2 x Wall pilasters (150 x 1800mm)
2. 1 x Door (600 x 1780mm)
3. 1 x Divider (1500 x 1800mm)
4. 2 x Support Legs
5. 3 x Hinges
6. 1 x Indicator Lock
7. 1 x Door Knob
8. 1 x Coat Hook
9. 1 x 900mm Top rail
10. 2 x U Profile (1800mm)
11. 2 x H Profile (1800mm)
12. 1 x L Profile (1800mm)
13. 1 x I Profile (1500mm)
14. 1 x Rubber Beading (1800mm)
15. Screws & Gittis

Hardware and Profiles

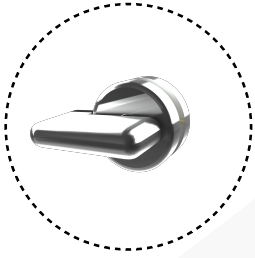

Indicator Lock

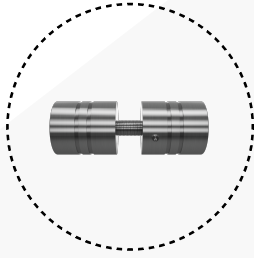

Door Knob



Coat Hook



Adjustable Leg



Hinge



Top Rail

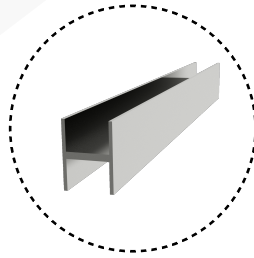

I-Profile

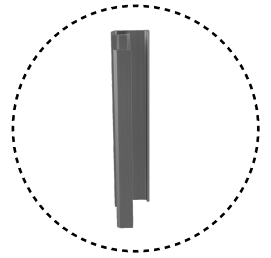

H-Profile

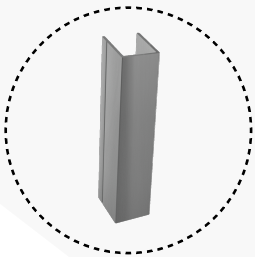

U-Profile

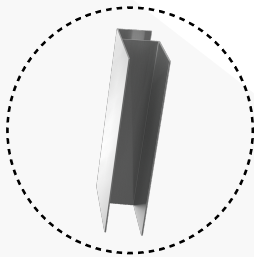

L-Profile

Tools required

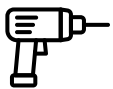

Hammer Drill



Circular Saw



Spirit Level

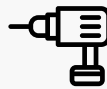

Cordless Drill



Tape Measure



Screwdriver



Pencil



Allen Key Set



Hammer

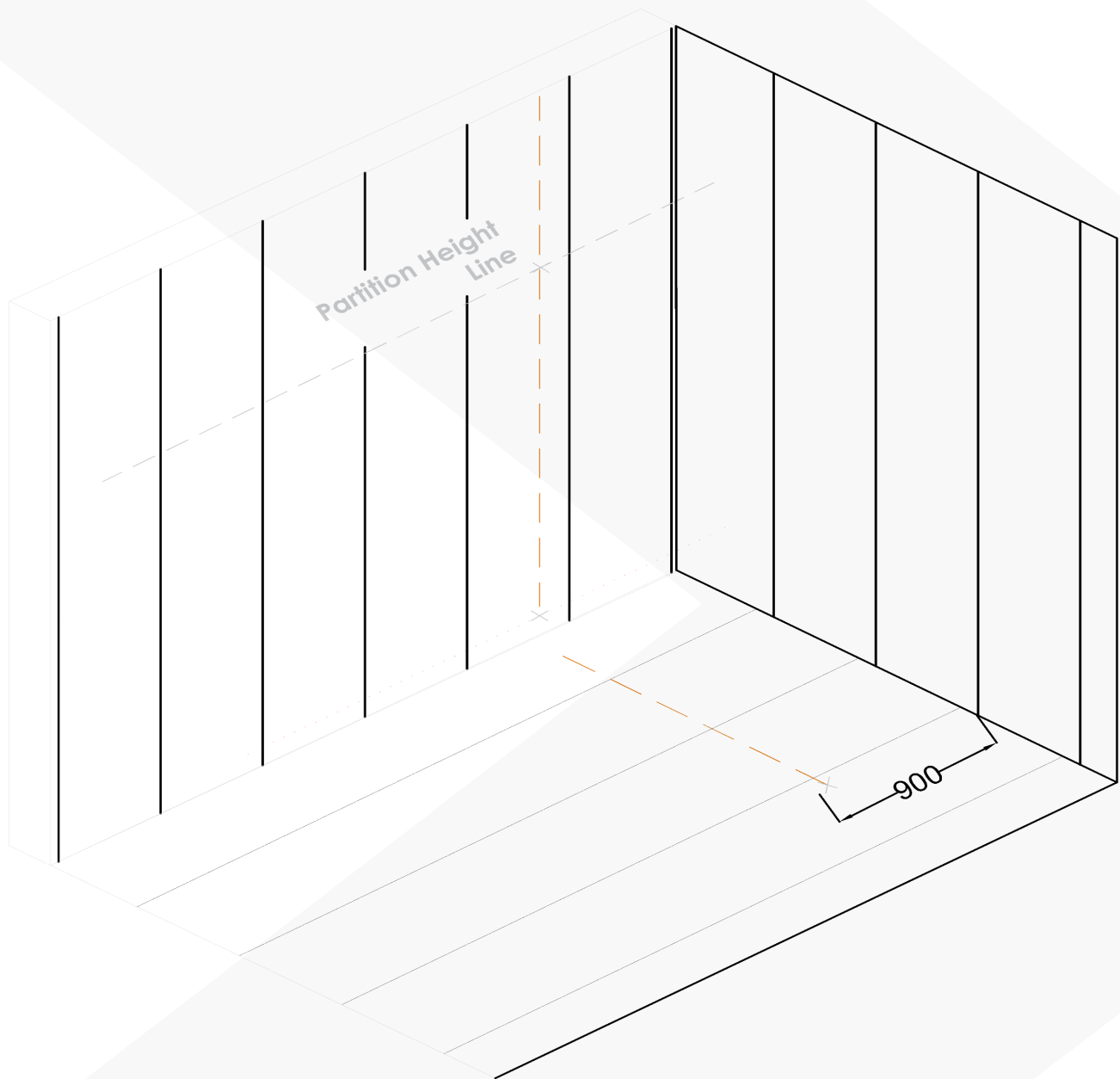

● Measure and mark a vertical line on the rear and right side wall of the partition and pilaster positions.

● Then mark the wall equally to fix 1x U-Profile per partition and end pilasters. Please see dimensions above for U-profile position.

Step 02

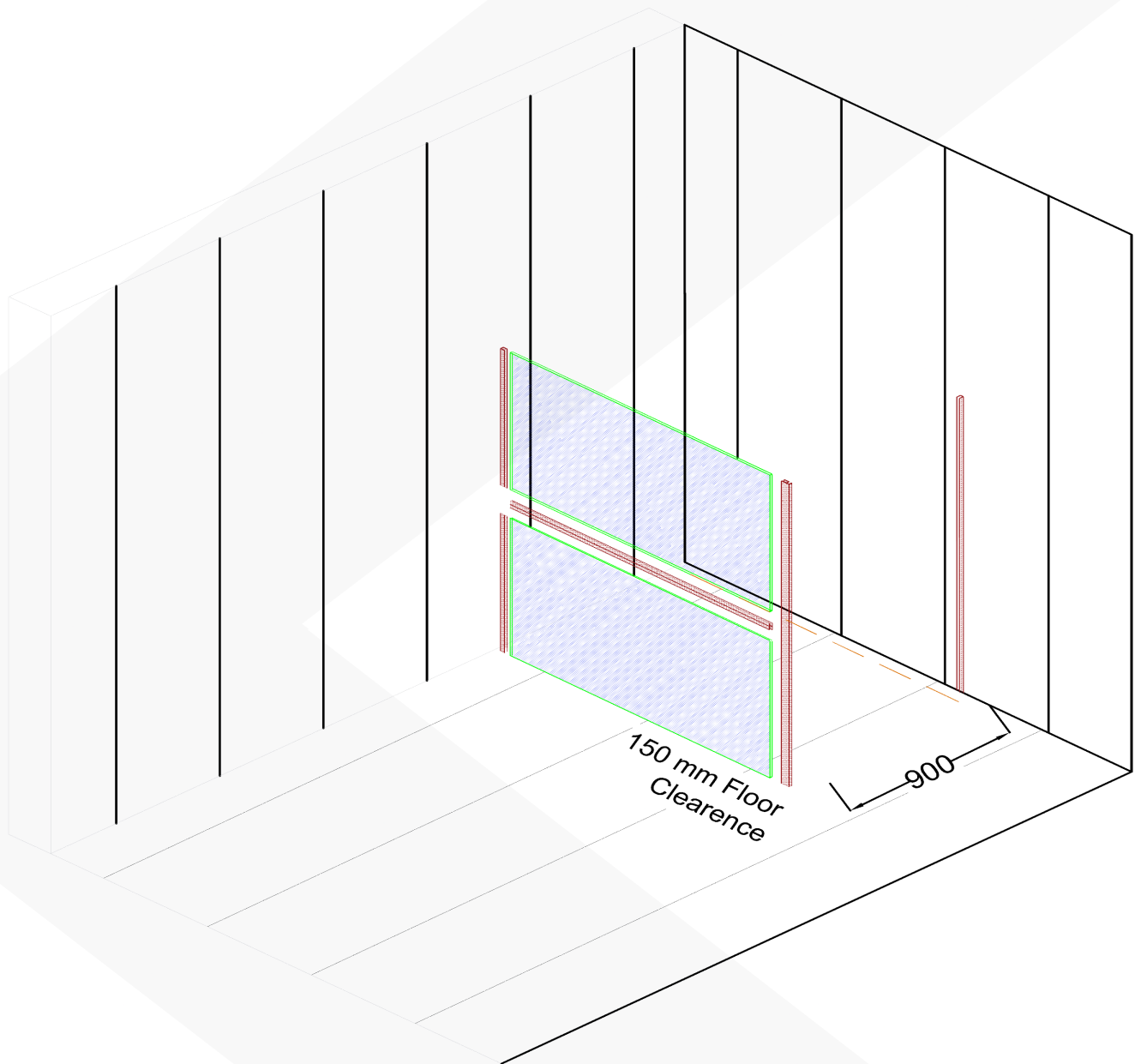

- Fix 1xU-Profile for each partition and pilaster on the vertical line marked.
- Cut the partition panels to size if required in depth.
- Place the bottom partition panel into the 1xU-profile on the back structural wall, securing the panel with fixings provided.
- Insert the I-channel joining strip onto the bottom partition panel

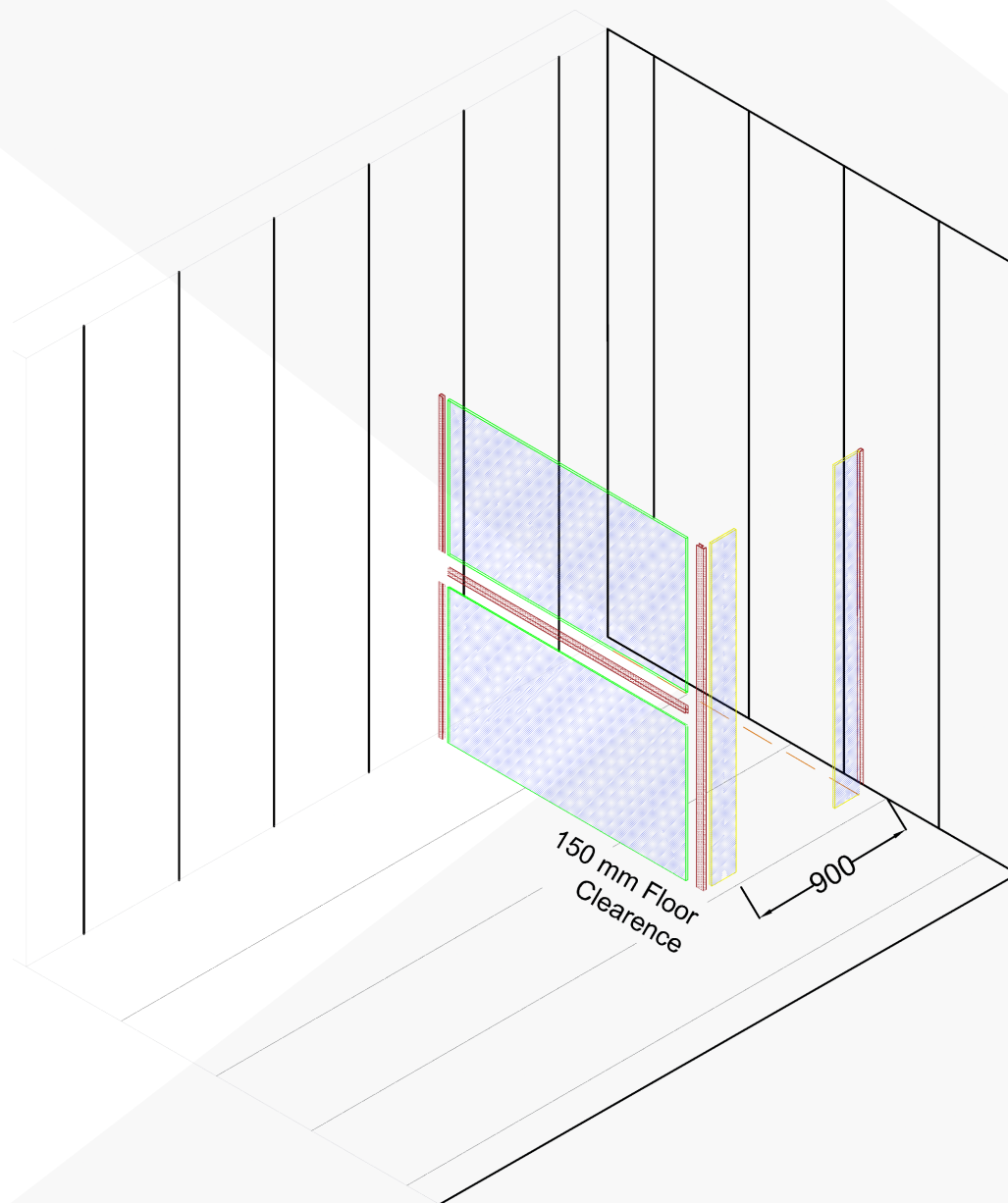

- Fix and secure wall pilaster into U-profile using the fitting provided.
- Fix U-profile to end pilasters, then secure the pilaster to the partition with fixings provided.
- Drill and fix the support leg onto bottom of the pilaster. Leg position should be at the centre of the pilaster.
- Wind the support leg until panel is level, then drill and secure leg to the floor.

Step 04

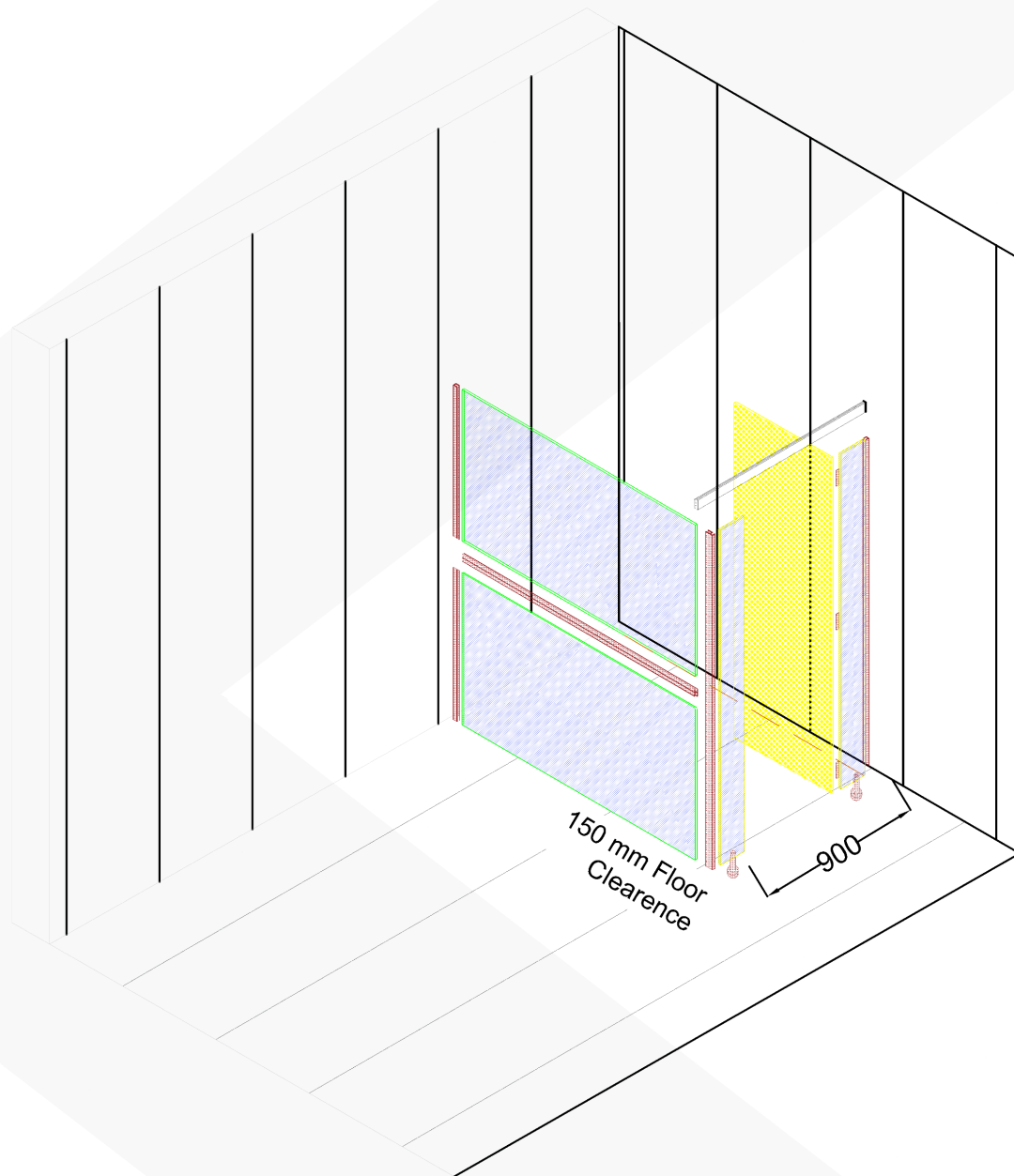

Mark and drill pilot holes in the top section of top rail to fix to each pilaster.

Drill and fix top rail down into the top of the front pilaster.

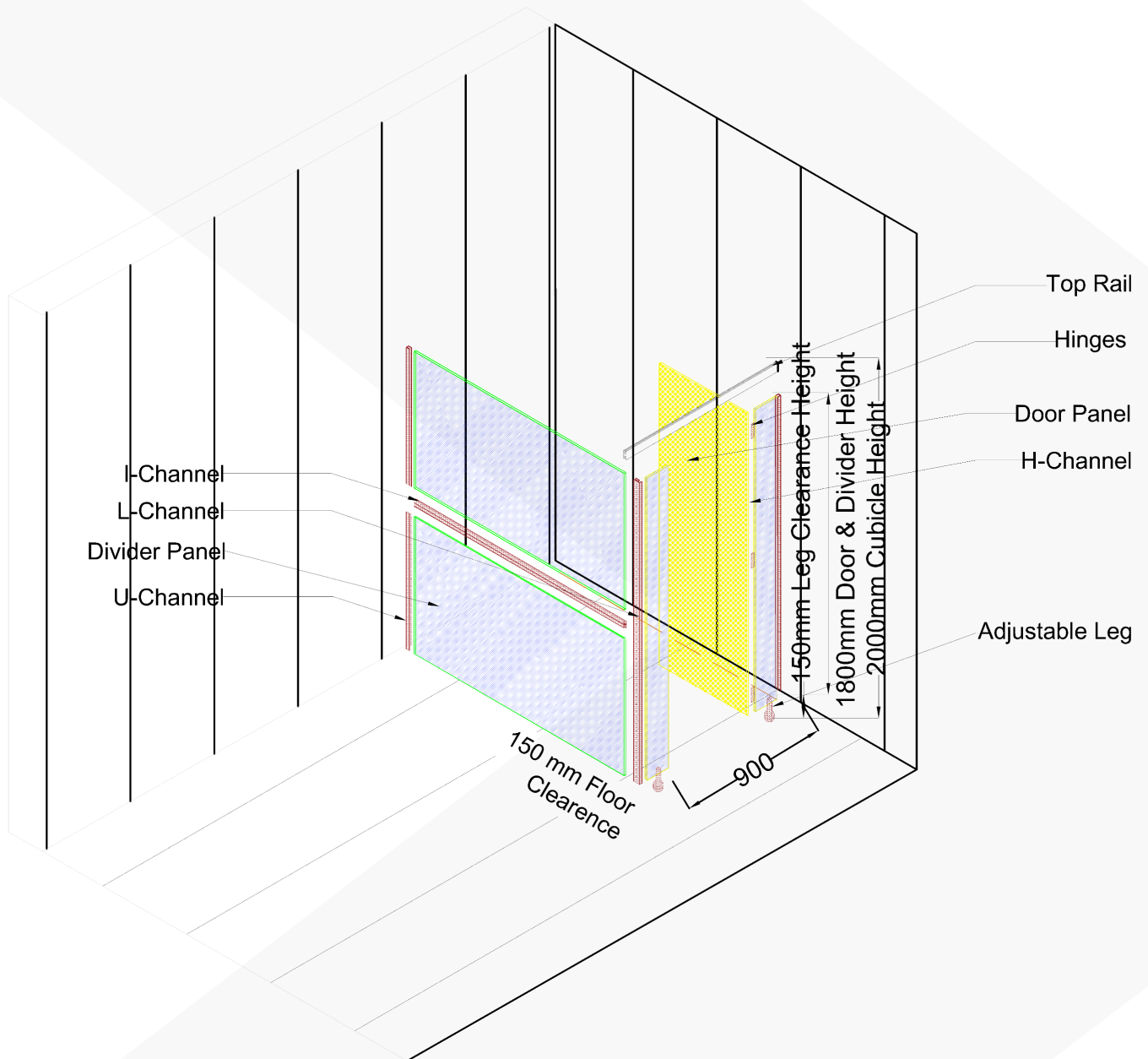

- Cubicle doors are adjustable in width. Cut the doors to the correct size you require.
- Door size will be of 600mm, fix door to the pilaster using fitting Hinges.
- Secure and fix the cubicle doors to the front pilasters by using the 3X gravity hinges.
- Install the indicator locks, door knob, and coat hook once doors have been fitted.
- For outward opening doors please use the outward opening lock. Latch, which is fitted to the outside of the pilasters.

This page intentionally left blank



Whatsapp Us



Expert Support

CUBICLE XPRESS

Delivery at the Speed of Business....

QR Code for download page



Cubiclexpress.com

